

5

#5-Main

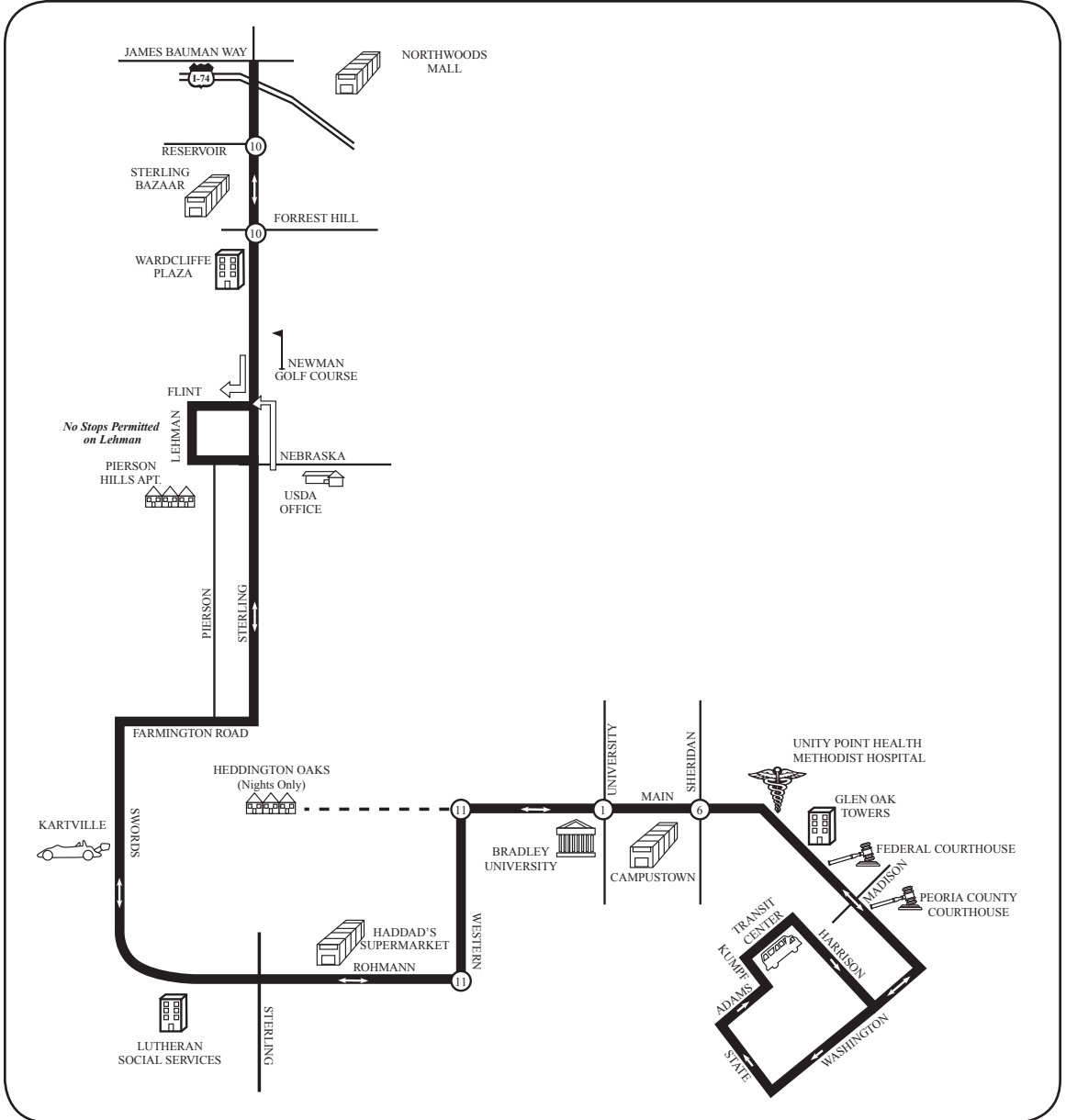

#5-MAIN

Times are approximate and may vary due to weather, road, and traffic conditions.

| LEAVE TRANSIT CENTER | MAIN & UNIVERSITY | ROHMANN & STERLING | PIERSON & NEBRASKA | STERLING & BAUMAN WAY | STERLING & BAUMAN WAY | PIERSON & NEBRASKA | ROHMANN & STERLING | MAIN & UNIVERSITY | ARRIVE TRANSIT CENTER |
|----------------------------|----------------------|-----------------------|-----------------------|--------------------------|--------------------------|-----------------------|-----------------------|----------------------|-----------------------------|
| MONDAY thru FRIDAY | | | | | | | | | |
| | | | FROM GARAGE | | 5:34 | 5:42 | 5:50 | 5:55 | 6:05 |
| | | | FROM GARAGE | | 6:04 | 6:12 | 6:20 | 6:25 | 6:35 |
| 6:15 | 6:25 | 6:30 | 6:38 | 6:46 | 6:39 | 6:47 | 6:55 | 7:00 | 7:10 |
| 6:45 | 6:55 | 7:00 | 7:08 | 7:16 | 7:09 | 7:17 | 7:25 | 7:30 | 7:40 |
| 7:15 | 7:25 | 7:30 | 7:38 | 7:46 | 7:34 | 7:42 | 7:50 | 7:55 | 8:05 |
| 7:45 | 7:55 | 8:00 | 8:08 | 8:16 | 8:04 | 8:12 | 8:20 | 8:25 | 8:35 |
| 8:15 | 8:25 | 8:30 | 8:38 | 8:46G | 8:34 | 8:42 | 8:50 | 8:55 | 9:05 |
| 8:45 | 8:55 | 9:00 | 9:08 | 9:16G | | | | | |
| 9:15 | 9:25 | 9:30 | 9:38 | 9:46 | 9:34 | 9:42 | 9:50 | 9:55 | 10:05 |
| 10:15 | 10:25 | 10:30 | 10:38 | 10:46 | 10:34 | 10:42 | 10:50 | 10:55 | 11:05 |
| 11:15 | 11:25 | 11:30 | 11:38 | 11:46 | 11:34 | 11:42 | 11:50 | 11:55 | 12:05 |
| 12:15 | 12:25 | 12:30 | 12:38 | 12:46 | 12:34 | 12:42 | 12:50 | 12:55 | 1:05 |
| 1:15 | 1:25 | 1:30 | 1:38 | 1:46 | 1:34 | 1:42 | 1:50 | 1:55 | 2:05 |
| | | | FROM GARAGE | | 2:04 | 2:12 | 2:20 | 2:25 | 2:35 |
| 2:15 | 2:25 | 2:30 | 2:38 | 2:46 | 2:34 | 2:42 | 2:50 | 2:55 | 3:05 |
| 2:45 | 2:55 | 3:00 | 3:08 | 3:16 | 3:04 | 3:12 | 3:20 | 3:25 | 3:35 |
| 3:15 | 3:25 | 3:30 | 3:38 | 3:46 | 3:34 | 3:42 | 3:50 | 3:55 | 4:05 |
| 3:45 | 3:55 | 4:00 | 4:08 | 4:16 | 4:04 | 4:12 | 4:20 | 4:25 | 4:35 |
| 4:15 | 4:25 | 4:30 | 4:38 | 4:46 | 4:34 | 4:42 | 4:50 | 4:55 | 5:05 |
| 4:45 | 4:55 | 5:00 | 5:08 | 5:16 | 5:04 | 5:12 | 5:20 | 5:25 | 5:35 |
| 5:15 | 5:25 | 5:30 | 5:38 | 5:46 | 5:34 | 5:42 | 5:50 | 5:55 | 6:05 |
| 5:45 | 5:55 | 6:00 | 6:08 | 6:16 | | | | | |
| 6:15 | 6:22 | 6:28 | 6:32 | 6:41 | 6:50 | 6:58 | 7:04H | 7:11 | 7:20 |
| 7:30 | 7:37H | 7:43 | 7:47 | 7:56 | 8:05 | 8:13 | 8:19H | 8:26 | 8:35 |
| 8:45 | 8:52H | 8:58 | 9:02 | 9:11 | 9:20 | 9:28 | 9:34H | 9:41 | 9:50 |
| 10:00 | 10:07H | 10:13 | 10:17 | 10:26 | 10:24 | 10:32 | 10:38H | 10:45 | 10:54 |
| 11:15 | 11:22H | 11:28 | 11:32 | 11:41 | 11:38 | 11:46 | 11:52H | 11:59 | 12:08 |
| 12:30 | 12:37H | 12:43 | 12:47 | 12:56G | | | | | |
| SATURDAY | | | | | | | | | |
| | | | FROM GARAGE | | 7:34 | 7:42 | 7:50 | 7:55 | 8:05 |
| 8:15 | 8:25 | 8:30 | 8:38 | 8:46 | 8:34 | 8:42 | 8:50 | 8:55 | 9:05 |
| 9:15 | 9:25 | 9:30 | 9:38 | 9:46 | 9:34 | 9:42 | 9:50 | 9:55 | 10:05 |
| 10:15 | 10:25 | 10:30 | 10:38 | 10:46 | 10:34 | 10:42 | 10:50 | 10:55 | 11:05 |
| 11:15 | 11:25 | 11:30 | 11:38 | 11:46 | 11:34 | 11:42 | 11:50 | 11:55 | 12:05 |
| 12:15 | 12:25 | 12:30 | 12:38 | 12:46 | 12:34 | 12:42 | 12:50 | 12:55 | 1:05 |
| 1:15 | 1:25 | 1:30 | 1:38 | 1:46 | 1:34 | 1:42 | 1:50 | 1:55 | 2:05 |
| 2:15 | 2:25 | 2:30 | 2:38 | 2:46 | 2:34 | 2:42 | 2:50 | 2:55 | 3:05 |
| 3:15 | 3:25 | 3:30 | 3:38 | 3:46 | 3:34 | 3:42 | 3:50 | 3:55 | 4:05 |
| 4:15 | 4:25 | 4:30 | 4:38 | 4:46 | 4:34 | 4:42 | 4:50 | 4:55 | 5:05 |
| 5:15 | 5:25 | 5:30 | 5:38 | 5:46G | 5:34 | 5:42 | 5:50H | 5:55 | 6:05 |
| 6:15 | 6:24H | 6:28 | 6:32 | 6:41 | 6:50 | 6:58 | 7:06H | 7:11 | 7:20 |
| 7:30 | 7:39H | 7:43 | 7:47 | 7:56 | 8:05 | 8:13 | 8:21H | 8:26 | 8:35 |
| 8:45 | 8:54H | 8:58 | 9:02 | 9:11 | 9:20 | 9:28 | 9:36H | 9:41 | 9:50 |
| 10:00 | 10:09H | 10:13 | 10:17 | 10:26G | | | | | |

H - This trip will serve Heddington Oaks on Heading Avenue. (Nights Only)

G - To Garage

LIGHTFACE denotes A.M. times

BOLDFACE denotes P.M. times

All Seniors (65 & older) pay 50¢ per ride.